

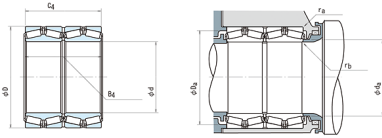

Timken BEARING CORP.of CANADA LTD.



368KV5251 NSK Four-Row Tapered Roller Bearing

Bearing No. 368KV5251

368KV5251 Bearing 2D drawings and 3D CAD models

hidYobi	368KV5251
LangID	1
ALP23	0
ALP22	0
D_	523.875
ALP21	25
C	5050
B_	382.588
hidTable	ecat_NSTPRF
RAr	1151
rb	3.3
mass	274
ra	6.4
D_a	487
C0	14900
SLR	75
Prod_Type3	TRBSR_FR_ID
da	396
d	368.3
BET21	1
BET22	55
BET23	0
C_	382.588
yobi	368KV5251
KBRG	3666



Timken BEARING CORP.of CANADA LTD.

DA1	38.501
DA2	35.998